



Republic of the Philippines
Department of Agriculture

PHILIPPINE FISHERIES DEVELOPMENT AUTHORITY

October 2, 2023

BID BULLETIN NO. 2023-08

Expansion and Improvement of General Santos Fish Port Complex Package 2 (Design and Build)

This Bid Bulletin is issued to revise and amend the drawings on the Conceptual Design.

Attached and made as an integral part of this Bid Bulletin No. 2023-08 is the revised Conceptual Design.

For any inquiries and questions, you may call us at **(02) 89256146** or send us an email to bac.co@pfda.gov.ph

For the guidance and information of all concerned.

ERNEST CARLO D. GARCIA
Head, PFDA BAC Secretariat



Management
System
ISO 9001:2015
www.tuv.com
ID 9109058343



PCA Annex Building
Elliptical Road Diliman, Q.C.
Telefax. No. 8925-61- 41
www.pfda.gov.ph



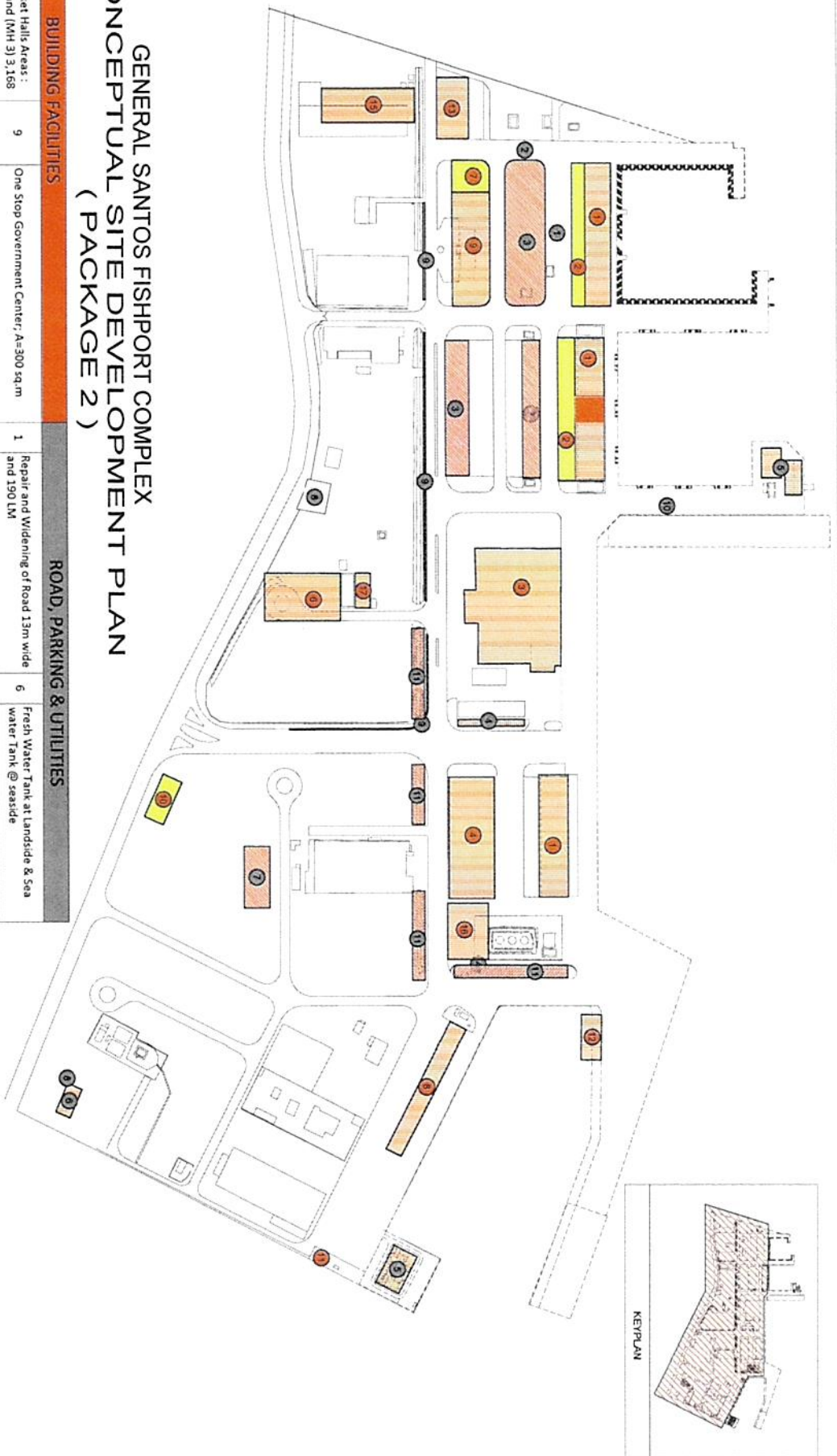

GENERAL SANTOS FISHPORT COMPLEX CONCEPTUAL SITE DEVELOPMENT PLAN (PACKAGE 2)

BUILDING FACILITIES			ROAD, PARKING & UTILITIES		
1	Rehabilitation of Existing Market Halls Areas : (MH 1) 1,150, (MH 2) 2,150 and (MH 3) 3,168	9	One Stop Government Center, A=300 sq.m	1	Repair and Widening of Road 13m wide and 190 LM
2	Construction / Extension of New Market Halls : (MH-1) 1,1840 sq.m; and (MH-2) 2,150 sq.m.	10	Construction of Building for Eco-Tourism; A=1,000 sq.m	2	Construction of New Road 9m wide and 110 LM
3	Rehabilitation of Existing Refrigeration Building A, A=6,700 sq.m	11	Improvement/Upgrade of Material Recovery Facilities	3	Conversion of Existing Net Mending Area to Parking Area; Total Area : 7,200 sq.m
4	Rehabilitation & Improvement of Refrigeration Building Plant B; A=7,300 sq.m	12	Construction of Office Building for CIDS (10-20m)	4	Repair & refurbishment of existing weighbridges & stations
5	Additional HOD office to be put-up at the roof top of MH-2	13	Construction of GAD Building with Guest House (400sqm)	5	Improvement of Water and Drainage System including WWTP's 1 & 2
6	Construction of 3-Storey Administration Building; A=2,000 sq.m	14	Construction of Toilet 1 (36sqm), Toilet 2 (18sqm) and Toilet 3 (30sqm)	11	Conversion of floodway into parking areas
7	Renovation and Improvement of dormitory/guest house; A=140 square meter	15	Construction of Service Facility-Processing Facility		
8	Rehabilitation & Improvement of Market Hall no. 4	16	Construction of Ice Plant (60tons)		
		17	Residence Engineers Office (REO) - Site to be identified		

LEGEND :

EXISTING MARKET HALL / FACILITIES

PROPOSED EXTENSION

PARKING AREA